

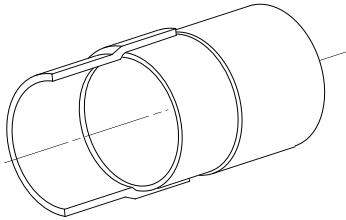

FIBERGLASS PIPE GROUP



Bondstrand RP6B Adhesive Kit

epoxy adhesive for bonding fiberglass pipe and fittings in potable water and food service

Description

RP6B is a two-part amine-cured epoxy resin system formulated for bonding permanent Quick-Lock joints on Ameron fiberglass-reinforced epoxy pipe and fittings. RP6B is FDA-approved for use in potable water and food lines. The RP6B adhesive kit contains resin, hardener, mixing spatula, paper towels and assembly instructions. A heat cure is required before joints are tested or put into service. The resin is a white paste with sand filler. The hardener is a black paste. The mixed adhesive is dark grey.

Instructions

After insuring that the bonding surfaces are dry and clean, completely mix all of the catalyst (hardener) with the resin. **Never split a kit.** Apply a uniform coat to both bonding surfaces and draw both parts firmly together. Required cure times must be observed. For service temperatures up to 150°F (66°C), a minimum cure of 30 minutes is recommended for joining pipe and mounting flanges and a minimum cure of 45 minutes for joining fittings. For service temperatures above 150°F(66°C), increase the cure times to 60 and 75 minutes, respectively. Detailed joint assembly instructions may be found in QUICK-LOCK INSTALLATION INSTRUCTIONS, FP170.

RP6B is a gap-filling adhesive designed to fill the space between the straight spigot and the slightly tapered bell (3) in the Quick-Lock joint. For proper adhesive distribution (2), apply a generous layer of adhesive to the outside of the spigot and a thin layer to the inside of the bell (1).

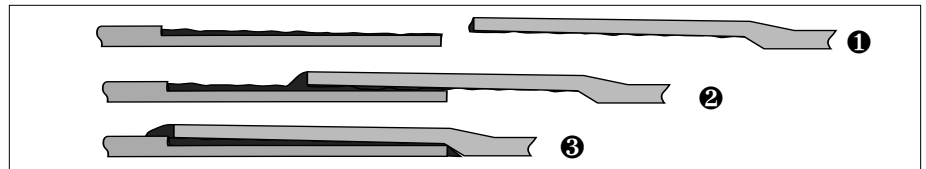

Adhesive kit sizes and bonds per kit

The values in this table are based on the quantity of adhesive required by an experienced crew working at a temperature of 80°F (27°C).

Kit Size	Total Pkg Wt	Bonds per Kit											
		Nominal Pipe Size (in/mm)											
(fl oz)	(lb)	1/25	1.5/40	2/50	3/80	4/100	5/125	6/150	8/200	10/250	12/300	14/350	16/400
3	¼	10	6	4	3	2	1	1	½	½	½	¼	¼
6	½	-	-	-	-	4	2	2	1	1	½	½	½

Important: Be aware of the working time available after the adhesive has been mixed. It may not be possible to achieve the listed number of bonds in the smaller sizes because of the available working time (pot life) of the adhesive. See the adhesive kit package for approximate working times.

Pot life

ISO-9001



CERTIFICATED FIRM

Pot Life and Cure Time (minutes)				
°F/°C	70/21	80/27	90/32	100/38
3-oz kit	50	30	20	9
6-oz kit	45	25	15	7

1) Pot life is measured from when resin and hardener are first mixed until the adhesive starts to thicken and harden and can no longer be used.

An external heat source must be used to force cure the adhesive. The adhesive and bonding surfaces should be warmed to 70°F (21°C) prior to mixing and applying the adhesive. Adhesive may be force cured using an Ameron-approved heating blanket.

Toxicity and precautions

Hardener — The hardener is irritating to skin, eyes and respiratory tract. It is toxic orally and may cause sensitization. Avoid contact with eyes, skin or clothing. Avoid breathing vapors. Wear rubber gloves and apron and NIOSH-approved respirator. Wash thoroughly after handling.

Resin — The resin may be mildly irritating to skin, eyes and respiratory tract. Avoid contact with eyes, skin or clothing. Avoid breathing vapors. Wear rubber gloves and eye protection. Wash thoroughly after handling.

First aid

In case of contact

Eyes — Immediately flush eyes with plenty of water for at least 15 minutes. Call a physician.

Skin — Wash skin with soap and water.

Clothing — Remove contaminated clothing and wash before reuse.

Inhalation — Remove to fresh air. Give oxygen or artificial respiration if necessary.

Ingestion — If catalyst is swallowed and person is conscious, give plenty of water or milk to drink. **Do not induce vomiting.** Call a physician. If resin is swallowed, give 100 grams (about 1/4 lb) activated charcoal slurry in water. **Do not induce vomiting.** Call a physician.

FOR CHEMICAL EMERGENCY
SPILL, LEAK, FIRE, EXPOSURE OR ACCIDENT
CALL CHEMTREC - DAY OR NIGHT: 1-800-424-9300
Toll-free in the continental U.S.
483-7616 in District of Columbia
For calls originating outside the continental U.S.: 202-483-7616 -
Washington, D.C., collect
ALL CALLS ARE RECORDED

Important Notice

This literature and the information and recommendations it contains are based on data reasonably believed to be reliable. However, such factors as variations in environment, application or installation, changes in operating procedures, or extrapolation of data may cause different results. Ameron makes no representation or warranty, expressed or implied, including warranties of merchantability or fitness for purpose, as to the accuracy, adequacy or completeness of the recommendations or information contained herein. Ameron assumes no liability whatsoever in connection with this literature or the information or recommendations it contains.



FIBERGLASS PIPE GROUP

Group Headquarters

P.O. Box 801148
Houston TX 77280
Tel: (713) 690-7777
Fax: (713) 690-2842
<http://www.ameron-net.com>

Fiberglass Pipe Division-Asia

Ameron (Pte) Ltd.
No. 7A, Tuas Avenue 3
Singapore 2263
Tel: 65 861 6118
Fax: 65 862 1302/861 7834

Fiberglass Pipe Division-Europe

Ameron B.V.
J.F. Kennedylaan 7
4191 MZ Geldermalsen
The Netherlands
Tel: +31 345 573-341
Fax: +31 345 575 254
Telex: 40257 bonds nl

Fiberglass Pipe Division-U.S.A.

P.O. Box 878
Burkburnett, Texas 76354
Tel: (817) 569-1471
Fax: (817) 569-2764